

THE INFORMATION CONTAINED IN THIS DRAWING IS THE SOLE PROPERTY OF CONE L.L.C. ANY REPRODUCTION IN PART OR IN WHOLE WITHOUT THE WRITTEN PERMISSION OF CONE L.L.C. IS PROHIBITED.

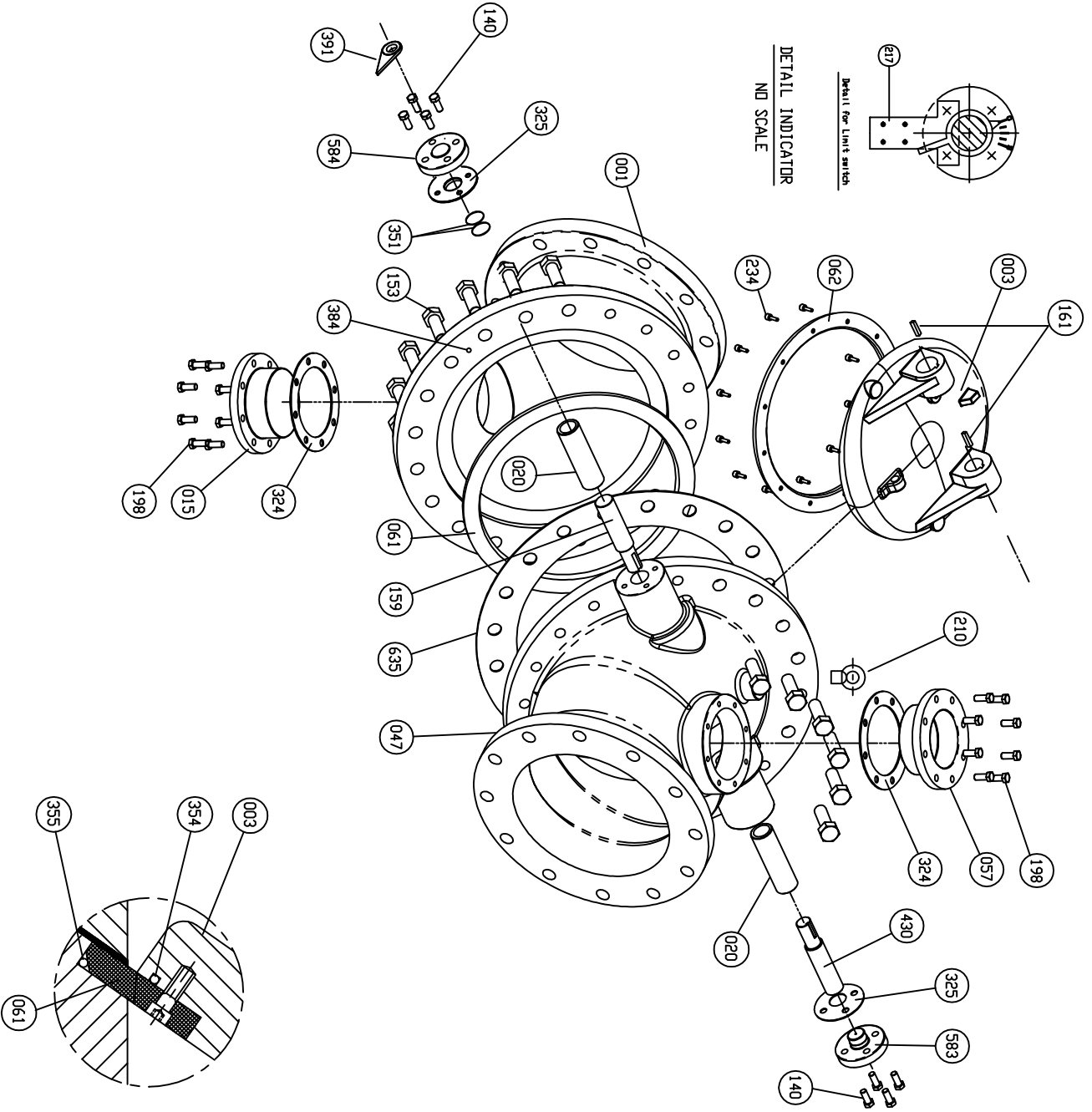

REV	DESCRIPTION	DATE	BY

635	Body Flanged Gasket	Non Asbestos Sheet		1
584	End Plate D	Bronze	B 62	1
583	End Plate C	Ductile Iron	A 536 Gr. 65-45-12	1
430	Hinge Pin B	Stainless Steel	A 276 Type 304	1
391	Needle	Aluminum		1
384	Pin	Stainless Steel	A 276 Type 304	2set
355	Body D-Ring	Rubber (Buna N)	D 2000 BK 707	1
354	Disc D-Ring	Rubber (Buna N)	D 2000 BK 707	1
351	D-Ring B	Rubber (Buna N)	D 2000 BK 707	2
325	Gasket C, D	Non Asbestos Sheet		2
324	Gasket A, B	Non Asbestos Sheet		2
234	Socket Head Bolt	Stainless Steel	A 276 Type 304	1set
217	Limit Switch Arm	Galvanized Steel		1
210	Eye Bolt	Galvanized Steel		1
198	End Plate Bolt A, B	Zinc Coated Steel	A 307 Grade B	2set
161	Key	Stainless Steel	A 276 Type 304	2
159	Hinge Pin A	Stainless Steel	A 276 Type 304	1
153	Body Bolt	Zinc Coated Steel	A 307 Grade B	1set
140	End Plate Bolt C, D	Zinc Coated Steel	A 307 Grade B	2set
062	Disc Seat Ring	Aluminum Bronze	B 148 Alloy C954	1
061	Body Seat Ring	Aluminum Bronze	B 148 Alloy C954	1
057	End Plate (A)	Ductile Iron	A 536 Gr. 65-45-12	1
047	Body B	Ductile Iron	A 536 Gr. 65-45-12	1
020	Bushing	Bronze	B62	2
015	End Plate (A)	Ductile Iron	A 536 Gr. 65-45-12	1
003	Disc	Ductile Iron	A 536 Gr. 65-45-12	1
001	Body A	Ductile Iron	A 536 Gr. 65-45-12	1

MATERIAL LIST

HYDRD SHELL	400	PSI.
HYDRD VALVE SEAT	200	PSI.
HYDRD BACK SEAT		PSI.
AIR SEAT		PSI.
STEAM		PSI.

TEST PRESSURE

WORKING PRESSURE	200	PSI.
------------------	-----	------

HENRY PRATT COMPANY

410 S. HIGHLAND AVE. AURORA, IL PHONE: 630-844-4000, FAX: 630-844-4320

SCALE	DATE	REV.
N.T.S.	8/14/08	

TITLED DISC VALVE AWMA C508
EXPLODED VIEW

MODEL	67125	DWG NO.	TDC-EXP	REV.
-------	-------	---------	---------	------